



VIN - 74019

## Pre-Owned 2020 Exiss Escape 7410 LQ



### CONSTRUCTION FEATURES

- 7'8" inside height - 7'0" outside width
- All aluminum construction w/ single piece aluminum roof
- Extruded plank flooring w/ 2" x 4" I-beams on 16" centers
- (2) 5,200 lb. rubber torsion axles w/ electric brakes (2H-3H)
- (2) 6,000 lb. rubber torsion axles w/ electric brakes (4H)
- Kingpin hitch w/ 2 5/16" adjustable coupler
- Breakaway switch w/ battery and slip hook safety chains
- Five 16" 6 hole aluminum wheels w/ 10 ply Rainier tires
- Spare tire w/ exterior mount
- Single leg hydraulic jack
- .040 white aluminum side sheets w/ stainless nose
- Extruded aluminum slat outside of horse area
- Tear drop fenders
- Full-width rear rubber bumper
- LED brake and running lights
- LED load light at rear of trailer
- Solid wall separating living quarters from horse area
- Walk-thru door from living quarters to horse area
- Fold-up step under camper door
- Camper door w/ sliding window, dead bolt and screen door
- LED lighted grab handle at LQ camper door
- Two outside tie rings per horse
- One egress 19" x 26" window on streetside of the gooseneck
- One 19" x 26" window on curbside of the gooseneck
- Dual battery box and propane tank tray under gooseneck
- 3/8 transferable warranty
- LED lighted grab handle at LQ camper door

### HORSE AREA FEATURES

- Horse area walls insulated and lined w/ white aluminum
- Rubber installed 48" high w/ white aluminum lining above
- Aluminum kickplate behind rubber lining
- Two inside tie rings per horse
- Lifetime rubber floor mat in horse area
- Streetside 27" x 31" heavy-duty feed doors w/ drop bars
- Curbside 27" x 31" windows w/ bars and screen
- Padded stall dividers w/ body, shoulder and head separator
- Fully recessed (patented) slam latch for divider
- Side access door w/ heavy-duty drop feed door (3H, 4H)
- One pop-up two-way aluminum roof vent per stall
- 55/45 rear doors w/ 19" x 26" window on load door
- Dual cam locks w/ lockable hasp on rear doors
- One interior LED light per divider in horse area
- One interior LED light in rear tack
- Fold-up rear tack wall (lined one side)
- Nylon safety straps at rear load door and side access door
- Adjustable saddle rack ( $\leq 4$ ) on removable post in rear tack

- Blanket bar, brush tray, clothes rod and six halter hooks

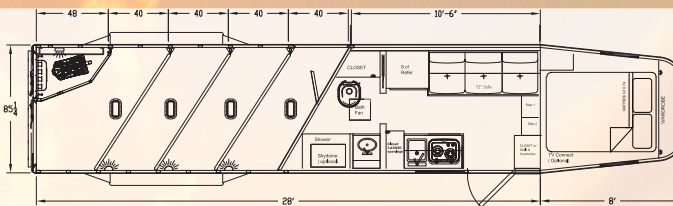

**7' Wide, 7'8" Tall**  
**4 Horse, 10'6" Living Quarters**  
**TRAILER IS ON CONSIGNMENT**  
**FULLY SERVICED AND INSPECTED**  
**NEW REAR BRAKES, BEARINGS REPACKED**  
**4.5 Year Structural Warranty**  
**5-Year Extended Protection With Emergency Road Service**  
**Available \$3,999**

### TRAILER FEATURES ADDED

Hayrack w/ Ladder  
 Metallic Black Side Sheets  
 Easy Care Flooring  
 Lower Divider Panel  
 Saddle Tier Mount In First Stall  
 2 Additional Halter Hook Bars  
 Camper Step On Escape Door

### INTERIOR FEATURES ADDED

Décor Color - Cheyenne Chocolate  
 Sky Dome Above Shower  
 Flip-up Counter-Top Extension  
 Solid Wood Cabinet Doors  
 Stainless Steel Appliances  
 LED Reading Lights  
 Sconce Lights x2  
 Air Conditioner Heat Strip 5,600 BTU  
 Outside Water Spigot  
 Satellite Input Jack - exterior  
 TV Antenna w/ booster  
 28" TV with Swing Arm  
 Crown Molding Upgrade  
 Oil Rubbed Bronze Hardware

**\$71,999**

YOUR PAYMENT	
MONTHLY	BI-WEEKLY
<b>\$637</b>	<b>\$294</b>
TERM/AM	INTEREST RATE
240/240	7.99%
<small>DAC: Finance fee of \$889 included in payment, cost of credit during term: \$76,727.75 (APR 6.75%)</small>	

### GENERAL FEATURES

- On demand pressure water system
- City water hook up
- 6 Gallon gas water heater (direct spark)
- 30-60 Gallon fresh water tank
- Two waste water holding tanks
- Tank monitor system
- 55 Amp power converter
- 14,000 BTU ducted furnace
- 13,500 BTU air conditioner
- CO2, LP, and smoke alarms
- LED exterior porch light
- 110V exterior receptacle & 120V (30 amp) shoreline
- Dual 20# LP Tanks w/ regulator
- Deep cycle marine battery
- Sewer hose & holder

### OVERALL INTERIOR FEATURES

- Vinyl wrapped cabinet doors w/ European hinges
- Vinyl wrapped cabinet faces, trim & door casings
- Decorative window trim w/ two tone valances
- Laminate counter/table top edges
- Pleated shades on all windows
- Panel walls & ceilings
- Soft touch cover on camper door & walk thru door
- Snap on privacy cover over camper door window
- LED courtesy lights in main area
- High intensity LED ceiling lights
- Brushed nickel pulls, faucets, hinges & accessories
- Commercial grade linoleum flooring
- Moisture resistant 3/4" subflooring
- Bluetooth enabled stereo w/ AM/FM/CD/DVD player
- Inside & outside stereo speakers

### MAIN LQ AREA FEATURES

- Jackknife sofa in main LQ area (dinette optional)
- Cabinets above sofa/dinette
- LED lighting under overhead cabinets in main area

### KITCHEN AREA FEATURES

- Cabinets under kitchen counter
- Drawers under kitchen counter
- Stainless steel sink
- Pull out faucet w/ sprayer
- Recessed (2 burner) stove w/ lid
- Lighted/vented range hood (black)
- 1.1 Cubic foot microwave (black)
- 8 cu ft refrigerator

### BUNK AREA FEATURES

- Inner spring full size mattress
- Tan carpet on bunk area floor
- Insulated bunk area floor
- Front wardrobe w/ two doors and middle storage
- USB charger in wardrobe area
- Shirt closet in bunk area

### BATHROOM FEATURES

- Hollow core pocket door to bathroom
- Bathroom sink w/ medicine cabinet above
- Linen closet w/ light & mirrored doors
- Large (white) shower w/ opaque glass door
- Porcelain foot flush toilet
- Power lift roof vent

MODEL	SIZE	STALLS	GVWR	EMPTY	AXLE
7410 LQ	7'0" x 28'0"	4H	12,500	7,740	(2) 6,000