



2025 Custom Horse Exiss Endeavor

8313 G-LQ



VIN 81503

CONSTRUCTION FEATURES

- 7'8" inside height - 8'0" outside width
- All aluminum construction w/ single piece aluminum rf
- Extruded plank flooring w/ 2" x 4" I-beams on 13" centr
- (2) 7,000 lbs. rubber torsion axles w/ electric brakes
- Kingpin hitch w/ 2 5/16" adjustable coupler
- Breakaway switch w/ battery and slip hook safety chains
- Five 16" 8 hole aluminum wheels w/ 14 ply gd yr tires
- Spare tire w/ exterior mount
- Dual leg hydraulic jack
- .040 white aluminum side sheets w/ stainless nose
- Extruded aluminum slat outside of horse area
- Tear drop fenders
- Full-width rear rubber bumper
- LED brake and running lights
- LED load light at rear of trailer
- Solid wall separating living quarters from horse area
- Walk-thru door from living quarters to horse area
- Fold-up step under camper door
- Camper door w/sliding window, dead bolt and screen dr
- LED lighted grab handle at LQ camper door
- Two outside tie rings per horse
- One 24" x 48" egress window in main LQ area
- One 15" x 26" kitchen window
- One 19" x 26" egress window on streetside of gooseneck
- One 19" x 26" window on curbside of gooseneck
- Dual battery box and propane tank tray under gn
- 6' slideout on streetside in living quarters area (Plan A)

HORSE AREA FEATURES

- Horse area walls insulated and lined w/ white aluminum
- Rubber installed 48" high w/ white aluminum lining above
- Aluminum kickplate behind rubber lining
- Two inside tie rings per horse
- Lifetime rubber floor mat in horse area
- Streetside 27" x 31" heavy-duty feed doors w/ drop bars
- Curbside 27" x 31" windows w/ bars and screen
- Padded stall dividers w/ body, shoulder/head divider
- Fully recessed (patented) slam latch for divider
- Mangers (3H) = 2 stalls, 2 doors
- Carpeted storage area beneath mangers
- Side access door w/ heavy-duty drop feed door
- One pop-up two-way aluminum roof vent per stall
- 55/45 rear doors w/ 19" x 26" window on load door
- Dual cam locks w/ lockable hasp on rear doors
- One interior LED light per divider in horse area
- One interior LED light in rear tack
- Fold-up rear tack wall (lined one side)
- Nylon safety straps at rear load door and side access door
- Adjustable saddle rack on removable post in rear tack
- Blanket bar, brush tray and six halter hooks

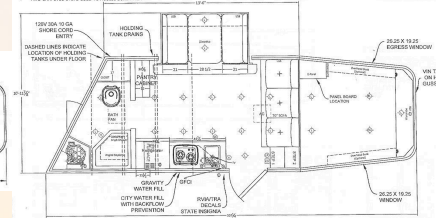
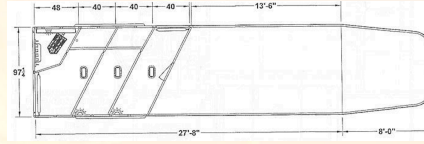

3 Horse, 14'6" Living Quarters w/Glide 8' Wide, 7'6" Tall, 27'6" Long

TRAILER FEATURES ADDED

- 6' Flush Floor Glide
- 27x31 Drop Down Feed Door ILO 27x31
- Window w/ Screen + Bars x3
- Lower Divider Panel - 8' Wide x2
- Flooring - Easy Care Flooring
- Air Flow Divider w/ Bars
- Butt/Breast Bar Aluminum (8' Wide)
- Hayrack

INTERIOR FEATURES ADDED

- Décor Color - Brownstone Latte
- Wooden Hat Rack x2
- Under Counter Lightning x2
- Hide-a-Screen Door
- 32" Smart TV w/Swing Arm
- Exterior Satellite Input Jack
- Sconce Lights x2
- Air Conditioner Upgrade - 15,000 BTU
- Ducted Ceiling for Air Conditioner
- Overhead Bunk Area Cabinets
- Fold Up Counter in Kitchen
- Crown Molding Upgrade

BATHROOM FEATURES

- Hollow core pocket door to bathroom
- Bathroom sink w/ medicine cabinet above
- Linen closet w/ light & mirrored doors
- Neo-angle (white) shower w/ opaque glass door
- Skydome above shower
- Porcelain foot flush toilet
- Power lift roof vent

GENERAL FEATURES

- On demand pressure water system
- City water hook up
- Outside water spigot
- 6 Gallon gas water heater (direct spark)
- 40 Gallon fresh water tank
- Two (31 gallon) waste water holding tanks
- Tank monitor system
- 55 Amp power converter
- 16,000 BTU ducted furnace
- 13,500 BTU air conditioner w/ heat strip
- CO2, LP, and smoke alarms
- LED exterior porch light
- 110V exterior receptacle & 120V (30 amp) shoreline
- Dual 20# LP Tanks w/ regulator
- Deep cycle marine battery

OVERALL INTERIOR FEATURES

- Raised panel solid wood cabinet doors w/ European hinges
- Vinyl wrapped cabinet faces, trim & door casings
- Decorative window trim w/ two tone valances
- Laminate counter/table top edges
- Pleated shades on all windows
- Panel walls & ceilings
- Soft touch cover on camper door & walk thru door
- Snap on privacy cover over camper door window
- LED courtesy lights in main area
- High intensity LED ceiling lights
- Brushed nickel pulls, faucets, hinges & accessories
- Commercial grade linoleum flooring
- Moisture resistant 3/4" subflooring
- Bluetooth enabled stereo w/ AM/FM/CD/DVD player
- Inside & outside stereo speakers
- TV antenna w/ booster

MAIN LQ FEATURES

- Jackknife sofa in main LQ area (dinette optional)
- Cabinets above sofa/dinette
- LED lighting under overhead cabinets in main area

KITCHEN AREA FEATURES

- Cabinets under & above kitchen counter
- Drawers under kitchen counter
- Double stainless steel sink
- Pull out faucet w/ sprayer
- Recessed (2 burner) stainless steel stove w/ lid
- Lighted/vented stainless steel range hood
- 1.5 cu ft stainless steel microwave
- 8 cu ft refrigerator
- Solid wood raised panel refrigerator door

BUNK AREA FEATURES

- Inner spring full size mattress
- Tan carpet on bunk area floor
- Insulated bunk area floor
- Front wardrobe w/ two doors and middle storage
- USB charger in wardrobe area
- Shirt closet in bunk area

MSRP: \$169,490

SALE PRICE: \$133,999

YOUR PAYMENT

MONTHLY	BI-WEEKLY
\$1271	\$586
OAC	OAC

TERM/AM: 240/240

INTEREST RATE: 8.99%

APR 9.75%

OAC, finance fee of \$599 included in payment, cost of credit during term: \$163,681.46.

**8 Years Structural / 3 Years On Components
Transferable Warranty**

MODEL	SIZE	STALLS	GVWR	EMPTY WEIGHT	AXLES
8314 GLQ - A	8'0" X 28'8"	3H	14,000	9,400	(2) 7,000
8314 GLQ - B	8'0" X 28'8"	3H	14,000	9,400	(2) 7,000