



VIN - 77096

# 2022 Exiss Stock Combo

## 8032 LQ - 7'8" Tall



### CONSTRUCTION FEATURES

- 7'8" inside height – 8'0" outside width
- All aluminum construction w/ single piece aluminum roof
- Extruded plank flooring w/ 2" x 4" I-beams on 13" centers
- (2) 8,000 lb. rubber torsion axles w/ electric brakes
- Kingpin hitch w/ 2 5/16" adjustable coupler
- Breakaway switch w/ battery and slip hook safety chains
- Five 16" 8 hole aluminum wheels w/ 14 ply Goodyear tires
- Spare tire w/ exterior mount
- Single leg hydraulic jack
- .040 white aluminum side sheets w/ stainless nose
- Extruded aluminum slat outside of horse area
- Tear drop fenders
- Full-width rear rubber bumper
- LED brake and running lights
- LED load light at rear of trailer
- 10'6" shortwall living quarters area
- Solid wall separating living quarters from mid tack and horse area
- Walk thru door from living quarters to mid tack
- Walk thru door from mid tack to horse area
- Fold-up step under LQ area camper door
- Two camper doors w/ 18" x 24" windows and screens
- LED lighted grab handle at LQ camper door
- Four outside tie rings per side
- One 24" x 48" egress window in main LQ area
- One 15" x 26" kitchen window
- One 19" x 26" egress window on streetside of gooseneck
- One 19" x 26" window on curbside of gooseneck
- Dual battery box and propane tank tray under gooseneck
- 3/8 transferable warranty

### HORSE AREA FEATURES

- Lifetime rubber floor mat in stock area
- Two air gaps with plexiglas tracks in stock area=
- Full swing center gate w/ hold back
- Heavy-duty slam latch w/ external release
- Heavy-duty 37" streetside access door (w/ matching air gaps)
- Full swing rear door (w/ slider & air gaps)
- Easy glide slider w/ handle on rear door (w/ air gaps)
- One LED dome light per compartment w/ switch on rear frame

### MID TACK FEATURES

- Pie shaped mid tack with 3' short wall
- Lifetime rubber floor mat in mid tack area
- Two LED dome lights
- Four tier adjustable saddle rack on removable post

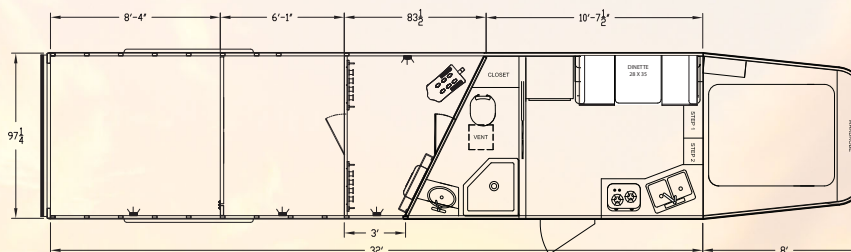

**This Unit is 8' wide and 7'8" tall  
14'6 Stock Back with a Mid-Tack and  
10'6" Living Quarters.**

### TRAILER FEATURES ADDED

- Hayrack w/ Foldout Ladder
- Fold-Down Camper Step
- Metallic Black Side Sheets
- Easy Care Flooring
- Tie Rings (2 per compartment)
- Plexiglass Inserts
- 54" wide Side Entry Ramp

### INTERIOR FEATURES ADDED

- Décor Color - Chestnut Hickory
- Overhead Cabinets in Bunk Area
- Flip-up Counter-top Extension
- Solid Wood Refrigerator Door
- Sink Cover/Cutting Board
- Solid Wood Cabinet Doors
- Dinette w/ Table
- Larger Mirror in main LQ
- Sconce Lights x4
- Furnace Upgrade 20,000 BTU
- Electric Awning with LED strip
- TV Antenna w/booster
- 32" TV with Swing Arm
- Oil-rubbed Bronze Hardware

**8 year Structural Warranty  
3 years on Components**

### GENERAL FEATURES

- On demand pressure water system
- City water hook up
- Outside water spigot
- 6 Gallon gas water heater (direct spark)
- 40 Gallon fresh water tank
- Two (31 gallon) waste water holding tanks
- Tank monitor system
- 55 Amp power converter
- 13,500 BTU air conditioner w/ heat strip
- CO2, LP, and smoke alarms
- LED exterior porch light
- 110V exterior outlet & 120V (30 amp) shoreline
- Dual 20# LP Tanks w/ regulator
- Dual deep cycle marine batteries
- Sewer hose & holder

MSRP: \$130,957

**SALE PRICE: \$112,000**

YOUR PAYMENT

MONTHLY	BI-WEEKLY
<b>\$914</b>	<b>\$421</b>
TERM/AM	INTEREST RATE
60/240	6.99%
	APR 7.68%

• A/C, finance fee of \$999 included in payment, cost of credit during term: \$22,303.99

### OVERALL INTERIOR FEATURES

- Raised panel solid wood cabinet doors w/ European hinges
- Vinyl wrapped cabinet faces, trim & door casings
- Decorative window trim w/ two tone valances
- Laminate counter/table top edges
- Pleated shades on all windows
- Panel walls & ceilings
- Soft touch cover on camper door & walk thru door
- Snap on privacy cover over camper door window
- LED courtesy lights in main area
- High intensity LED ceiling lights
- Brushed nickel pulls, faucets, hinges & accessories
- Commercial grade linoleum flooring
- Moisture resistant 3/4" subflooring
- Bluetooth enabled stereo w/ AM/FM/CD/DVD player
- Inside & outside stereo speakers
- TV antenna w/ booster

### MAIN LQ AREA FEATURES

- Jackknife sofa in main LQ area (dinette optional)
- Cabinets above sofa/dinette
- LED lighting under overhead cabinets in main area

### KITCHEN AREA FEATURES

- Cabinets under & above kitchen counter
- Drawers under kitchen counter
- Double stainless steel sink
- Pull out faucet w/ sprayer
- Recessed (2 burner) stainless steel stove w/ lid
- Lighted/vented stainless steel range hood
- 1 cu ft stainless steel microwave
- 8 cu ft refrigerator
- Solid wood raised panel refrigerator door

### BUNK AREA FEATURES

- Inner spring queen size mattress
- Tan carpet on bunk area floor
- Insulated bunk area floor
- Front wardrobe w/ two doors and middle storage
- USB charger in wardrobe area
- Shirt closet in bunk area

### BATHROOM FEATURES

- Hollow core pocket door to bathroom
- Bathroom sink w/ medicine cabinet above
- Linen closet w/ light & mirrored doors
- Neo-angle (white) shower w/ opaque glass door
- Skydome above shower

MODEL	SIZE	GVWR	EMPTY	AXLE
STC 8032 LQ - 7'8" Tall	8' x 32'0"	16,000	9,140	(2) 8,000

