

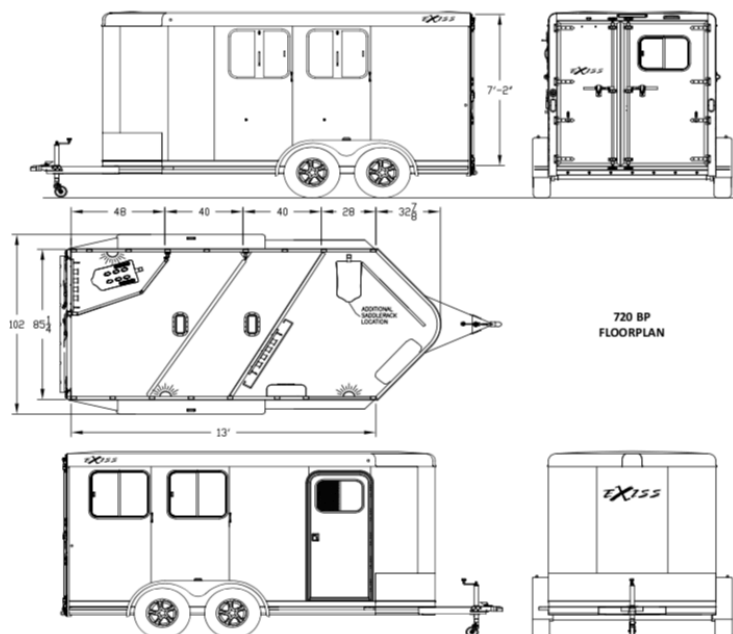

## 2023 EXISS 720 BP

### CONSTRUCTION FEATURES

- 7'2" inside height – 7'0" outside width
- All aluminum construction w/ single piece aluminum roof
- Interlocking extruded plank flooring w/ 2" x 4" I-beams on 16" centers
- (2) 3,500 lbs. rubber torsion axles w/ electric brakes (2H)
- (2) 5,200 lbs. rubber torsion axles w/ electric brakes (3H)
- Aluminum V-hitch w/ 2 5/16" adjustable coupler
- Breakaway switch w/ battery and slip hook safety chains
- Five 15" 6 hole aluminum wheels w/ 8 ply import tires
- Spare tire w/ interior mount
- 2,000 lbs. top-wind jack w/ wheel
- Treadplate gravel guard 16" high on nose
- .040 white aluminum side sheets
- Full length running boards w/ tear-drop fenders
- Full-width rear rubber bumper
- LED brake and running lights
- LED load light at rear of trailer
- Solid wall separating dressing room from horse area
- Two outside tie rings per horse
- 3/8 transferable warranty



### HORSE AREA FEATURES

- Horse area walls insulated and lined w/ white aluminum
- Rubber installed 48" high w/ white aluminum lining above
- Aluminum kickplate behind rubber lining
- Two inside tie rings per horse
- Lifetime rubber floor mat in horse area
- Streetside 27" x 31" drop feed windows w/ drop down bars
- Curbside 27" x 31" windows w/ bars and screen
- Padded stall dividers w/ body, shoulder and head separator
- Fully recessed (patented) slam latch for divider
- One pop-up two-way aluminum roof vent per stall
- Double rear doors w/ cam locks and locking hasps
- One 19" X 26" window in rear loading door
- One interior LED light per divider in horse area
- One interior LED light in rear tack
- Fold-up rear tack wall (lined one side)
- Nylon safety strap at rear load door
- Adjustable saddle rack on removable post (one per horse) in rear tack
- One set of six halter hooks in rear tack

### OPTIONAL EQUIPMENT

- *Easy Care Flooring ILO Rubber Mats*
- *LED Strip Light 22' Long in Dressing Room*
- *Metallic Black Sheets*
- *Air Flow Divider w/ Bars*

MSRP: \$42,735

SALE PRICE: **\$37,499**

YOUR PAYMENT	
MONTHLY	BI-WEEKLY
<b>\$384</b>	<b>\$177</b>
<small>OAC</small>	<small>OAC</small>
TERM/AM	INTEREST RATE
240/240	9.99%
	APR 10.87%

OAC, finance fee of \$399 included in payment, cost of credit during term: \$52,312.90

### DRESSING ROOM FEATURES

- 2'4" shortwall dressing room w/ carpeted floor
- One interior LED light in dressing room
- Camper door w/ sliding window and screen door
- Additional saddle rack location
- Blanket bar, brush tray, clothes rod and six halter hooks

**WARRANTY**  
**8 year structural**  
**3 years on components**

MODEL	SIZE	STALLS	GVWR	EMPTY WEIGHT	AXLES
720 BP	7'0" X 13'0"	2H	7,000	2,900	(2) 3,500